



Hunt Institute for Botanical Documentation
5th Floor, Hunt Library
Carnegie Mellon University
4909 Frew Street
Pittsburgh, PA 15213-3890
Contact: Archives
Telephone: 412-268-2434
Email: huntinst@andrew.cmu.edu
Web site: www.huntbotanical.org

The Hunt Institute is committed to making its collections accessible for research. We are pleased to offer this digitized version of an item from our Archives.

Usage guidelines

We have provided this low-resolution, digitized version for research purposes. To inquire about publishing any images from this item, please contact the Institute.

About the Institute

The Hunt Institute for Botanical Documentation, a research division of Carnegie Mellon University, specializes in the history of botany and all aspects of plant science and serves the international scientific community through research and documentation. To this end, the Institute acquires and maintains authoritative collections of books, plant images, manuscripts, portraits and data files, and provides publications and other modes of information service. The Institute meets the reference needs of botanists, biologists, historians, conservationists, librarians, bibliographers and the public at large, especially those concerned with any aspect of the North American flora.

Hunt Institute was dedicated in 1961 as the Rachel McMasters Miller Hunt Botanical Library, an international center for bibliographical research and service in the interests of botany and horticulture, as well as a center for the study of all aspects of the history of the plant sciences. By 1971 the Library's activities had so diversified that the name was changed to Hunt Institute for Botanical Documentation. Growth in collections and research projects led to the establishment of four programmatic departments: Archives, Art, Bibliography and the Library.

PERFECTION

**NOTE
BOOK**



No. M 524

JUNIOR SIZE

19

E. LUCY BRAUN
270 2 MAY ST
CINCINNATI, OH

Summer, 1935, II

"South America"

June 23, Big Log Mt
to Henderson S. S.

June 24 Pine Mt
" 25 Limestone Cr
Pine Mt

" 26 Chenow to
Clear Cr, Spr.

(all tree counts transferred
to cards)

June 23, 1935
Big Log Int, Bell Co.

meso to top - on
 S. d. rd., with
 basswood mingling with
 the hickory : 20

Basswood		11
chestnut		8
tulip		2
currant		1
hickory	Colts =	1
cherry		1
S. maple		21
wh oak		3
butternut		7
hickory		
red oak		
locust		
ash		4
walnut		

dogwood to the top

very dense & deep lower
layers

Aster

Bignonia

NW slope sort of
hemlock in

very deep

Soil profile is shown
in cut, material
deriving from shaly
formation.

Digitized by Hunt Institute for Botanical Documentation

Ferns -

Pheg.

Adiantum

Utricularia sp.

Cinnif.

Hypnum sp.

Asplenium sp.

Clematis

Helianthus (Bl. m.)

Rubus allegh.

Emp. vertic.

Impatiens

(A convexity of slope
more chestnut)

(2)

S Maple	###	9
hassard	###	5
hickory		3
sh & hick		1
C. cord		1
chestnut	###	8
locust		2
ash		2
walnut		2
red oak		1
tulip	###	7
wh oak		2
red oak		2

Digitized by Hunt Institute for Botanical Documentation

Buttercup	Aruncus
bloodroot	Thalictrum
Pedicularis	Lasiosora
Geranium	Aster cord
Smilax	Steir. <u>Benthamia</u>
Th.	

A convexity of slope:

(3)

wh oak			5
tulip			6
red oak	###		7
chestnut	###		8
hickory	###		6
S maple			5
hassard			1
hickory			1
ch oak			4
locust			1
hassard			1

Red maple 1 Hunt place
 Frax. Douglasii Steins Bank
 " oak
 Liriodendron
 Galium lance

becoming more curved
 & ch. oak more
 (4)

ch oak IIIIIIIIIII
 chestnut IIII
 red oak 1
 Tulip II
 red maple 1

Digitized by Hunt Institute for Botanical Documentation

Looking across to
 east slope:
 Prominent trees are
 S. maple
 basswood
 chestnut
 tulip

A massive sandstone
 more ch oak - chestnut
 on SW local

Meso: - again
 Caulophyllum
 Psedera

Misc. plants
Irad. flexuosum
Cuscuta
Polyg. Senega lat
Lilac
Vicia cr
Oxalis grandis
Anem. mollis
Sambucus
Smilax securis
Aspl. imp
Boragin
Polystich
Hedera, pointed leaf rock
Cuscuta

Digitized by Hunt Institute for Botanical Documentation

Cross creek what
is flowing west

beech starts on s. slope
in prairie along w
ch. oak, chestnut
tulip & s. m

& in prairie with
h-h-s.m-t.

beech Hickory
tulip
s maple
baswood
buckeye
ch oak
red oak
walnut
nyssa

South slope, magnif
 ch. oak with adm
 of wh oak, buckeye
 ash maple chestnut.
 (red azalea)

A community on S. slope
 ch. oak with Kalmia
 below (also more
 sandy here)
 ch oak - ch

(a wet spot - L. borealis
 Lobelia sylv
 Ran. recurvatus)

Digitized by Hunt Institute for Botanical Documentation

(5)
 A shallow ravine or community
 cut in south slope
 wh oak IIII 7
 tulip III 3
 chestnut IIII 4
 beech II 5
 w. oak I 1
 Nyssa III 3
 ch oak III 5
 cucumber I 1 / 29
 VALLEY

Down in broad (dend)
 valley.

A swamp:

Juncus spp - Jeffers
 Cicuta mac
 Nymphaea ~~sp~~ status
 Bohmeria rugosa
 Polyp. sag

a S.E. slope - remnants
of
br. oak, beech

bar oak
Spargan
red azalea
Halethra

Around W Laurel Creek
on flat.

a south slope SSE
beech - wh oak - Palmetto

(Hemlock + Rhod)
(near stream)

Digitized by Hunt Institute for Botanical Documentation

to more ch. oak
on S

A small prairie in
the valley along
north to Laurel C.

Beech - hemlock (u) ✓

beech ###

hemlock ###

red maple 1

ch oak 1

red oak 1

A very low flat topped
bit of sandstone
drops off into Laurel
Creek, about north slope
all M.M. - i

(2)

Nyssa 1
 cucumber 1
 chestnut 11
 red oak 11
 tulip 11
 ch. oak 111
 s. maple 111
 beech 1
 basswood 11
 wh oak 11
 red maple 1
 C. alba 111

Many blocks of
 stream around ^{Polypody} ^{Samolus}
 not the rich herb.
 layer of the out slope
 with Dryd, holly,
 dogwood, Amnigena and
 red maple under

Digitized by Hunt Institute for Botanical Documentation

A little side branch (3)
 flowing NE (Picture 4)

beech 1111111111	17
Chestnut 11	2
red maple 11	2
hemlock 111	3
cucumber 111	3
red oak 1	1
basswood 1	1
wh oak 1	1
elm 1	1
Rhod	
Amnigena	

Selaginella up
 Polypoda (red maple)

(4)

gray west -

	{ 4, 4, 5, 3, 5	74
beech	{ 17, 5, 12, 4, 5, 10	
nyssa	## 1	6
chestnut	### 11	8
oak	1	1
maple	## 11	9
tulip	111 - stumps ## 1	10
Something taken out, tulip		
red oak	## ## 11	12
hemlock	11	2
basswood	11	2
red oak	1 1	stump 1
maple	1	
Magnificent forest		
Pictures 5 - 8		

Digitized by Hunt Institute for Botanical Documentation

not much ground cover

- Asarum arif Mitchell
- V. rot Eup. white
- Gastero Eum. am
- Dioscorea japon
- Asp. n. b
- Polyst Rhod
- Hepatic
- V. blanda
- Traveller
- Phegop
- And. sep
- Anem. gray
- Pyrola

Rhod - Hemlock
 Magn. forest

Spartan *risolomus*
Settlement
From slopes all
and you truly
all above is 9/11

Digitized by Hunt Institute for Botanical Documentation

6-24-35
Pine Mt. opp.
Henderson Settlement

On first rock outcrop
little *Cichoreae* (Stearns)
Corydalis semper
Arabis canad

Aspl. platyneuron
in partly shaded
rocks

For a long way ascent
follows almost a
rock with top
shallow soil very
alt. with sandy slope

veg (picture 11)

a very pub. barium

Dasystoma (glan & cut) wood
Desm. heavy rough

Leaves sandstone slope
& circle horz. into
a diff slope ravine

Changes to tall Chkal
etc tall chestnut, occ. birch
ravine not gorge-like
but open ∇ directly
to south

lots of red azalea

Digitized by Hunt Institute for Botanical Documentation

Rhod - Kalmia thickets
with Clethra, Pyrus
Hamamelis, bad coryn
holly, etc
(fire pink on rocks)

From summit of
Pine Mt. -
valley of Poplar Creek
below

SE Slope facing us
has a line of cliffs
 $\frac{1}{3}$ + way up which breaks
forest; otherwise, forest
is unbroken through
entire visible area
except in valley of

Cumberland (?) many miles
to west.

Entirely mixed deciduous
forest except for
small patches of pine
just above cliff on
opp. mt face.

Forest varies somewhat
in composition with
slope exposure.

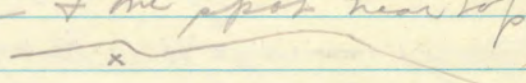
The opposing slope (SE)
has no basswood except
low + one spot near top
at 

Digitized by Hunt Institute for Botanical Documentation

The slopes of Pine Mt
are as seen in Harlan +
Letcher cos. - M. M. esp.
The SM-B-t-tulip cont.

Beech comes up the
valley of Poplar creek
+ a short way up both
slopes.

The SE. slope has
some tulip, the Pine
Mt slope has much
tulip.

Off ~~the~~ the higher skirt
of farther bridge at left
of pavilion, a tiny
patch of 2nd growth tulip

Chestnut is mixed all
thru the meso forest
(with the basswood)

Appears to be more chestnuts
in meso forest of Pine
Tnt than on opp SE
slope, except where
that slope it is localized
on that slope

The summit cliffs
have heaths on steep
slope

A gap in summit -
red agale

Digitized by Hunt Institute for Botanical Documentation

Summit cliff (?) on
flat topped part of
Tnt -

Quercus tree

Aralia sp.

lots of red bud in the

Flat-topped summit
is open chestnut
oak forest (picture 4)

A low broad flat of summit;
in add to ch. oak has
big white & chestnut
scattered in ch. oak; also
walnut, hickory (*glabra*,
alba,) black oak

P.M.

North side of Pineda

Nettle	Aspl. ang
Eup. vert	Polyst
Alseodora	Asp. mang
Caulephy	Adiant
Impatiens	Cyst frag
Geranium	Phryopteris
Smilax lac (in berries)	Botry. virg
Green violet	Hesper. acum
Cumcufy	V. papil
blodrop	Anemone
Solidago lat.	Smilax
Asarum can	Ochlopect
Viola can	Utricularia
Papaver	Amphicarp
dogwood	Hesperomitan

Digitized by Hunt Institute for Botanical Documentation

Psephora	Polygonata
Hydr	Solidago can
Menisap	Amp. ^{acum} amer
Arist. macro	Arcaea
Yates cord	Trillium ge
redbud	p, ^{erect} ^{virg}
Bign. cap	Celastrus
walking ferns	Smilax hisp
Carpinus	Yib. acer
	Hesper. acum

Dunes, in beach

Asarum on start, beach
 Hepatic ^{v. e. is in I & II}

Cucumber tree 12 ft 3"
~~3 1/2 x string~~

Ascent from creek
at base of north
side;

~~bottoms~~
beech, tulip,

Lower slopes

65

beech 51
chestnut 11
hemlock 1
Carpinus 111
tulip 111
s. maple 111
basswood 1
magn. tree 1

I

Digitized by Hunt Institute for Botanical Documentation

cucumber

the big
me

beech					1	21
cucumber	111					3
red oak	111					3
tulip	111					4
butternut	111					3
basswood	111					4
tree						
mulberry	111					3
elm	1					1
locust	1					1
chestnut						5
nyssa	11					2
ash	111					4
hickory	1					
Sassafras	1					
buckeye	1					

57

III

s. maple	### 1111	9
buckeye	### 111	9
hickory	### 11	7
beech	1111	(low) 4
tulip	### 111	8
red oak	111	3
ash	111	3
chestnut	1111	4
Sassafras	1	1
cucumber	111	3
hickory ^{alba}	11	2
Cladrastis	11 tall but slender	2
		53

Digitized by Hunt Institute for Botanical Documentation

IV

tulip	### ### ### 1711	24
s. maple	### ### ### ###	21
buckeye	### ###	10
chestnut	111	3
hickory	### 1111	9
beech	1	1
cucumber	111	3
sh b hickory	1	X
red oak	11	2
ash	### 11	7
ch oak	11	2
sh b beech	11	3
hickory	111	3
Sassafras	1	1
Nyssa	11	2
walnut	1	1
		92

ch	###	###	1	July	11
erc	###		1	July	6
smuple	###				5
luly	###	###	###		13
ch out	###				3
basswood	###		###		8
ash	###			July	4
burkeye					1
nyssa	###				3
C. glabra					1

55

92

53

59

65

324

Digitized by Hunt Institute for Botanical Documentation

shrub
Herb. list cont: -

Podophyllum
Saururus sp

Carex lax

Cladrastis (a small one)

Alentorea diph

Collinsonia

Sedum

Hepatica

For list of flora
of lowest section
beech, see pp after
picture legend

lighting + tobacco
 with many. tobacco
 things; what these are
 becoming

4 [] open the door
 and find 7
 feet of light

arrangement of the mt

A. from forest floor

to summit; the

add. in ch. var.

has long thick & slender

pedicels in. of var.

also - radium, anchovy

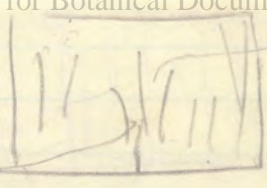

brushings
 not used

mark with of pan m
 12.9 (m.t. fresh 3x do stem + 6m
 brushings, 2x do stem = 13.4.3
 brush 2x + tobacco = 9.18

6 A group of 5 hills

hills, all scale of

from mt, grass 33

meadow tree, (1 + 4 knots)

about 7 ft 7 ft

7 (left) brushings (the) about 5 m, 2

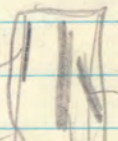

8 "Country Pal" in Pan
 m, beer at

(Penta. curvum)

9. M. Murphy (older hills)
 at elev 2000 + brushings

10. Dean Creek at
 11. Spar

6- all back wings
100 samples

7- all back all back

8- trip (left) +
back

(nos 5-8 in brown ink)

9. "County head" in
Bole Co. many

to J. S. S. S. S. S.

10 S. A.

long mt (open) +
but right for shape
and by. keep

11. On Pine mt of the

St. S. S. S. S. S.

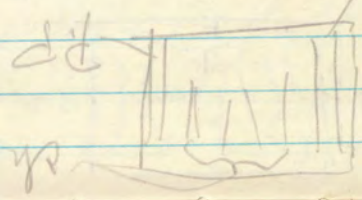

Open ground mt
make pins first +
mt, keep

R43

12, 1, 2. Parsons

Pin mt of the
St. S. S. S. S. S.

12, - NE

1, N - toward
2 SW

3. Pine mt slope (part
of Parsons)

to show forest -

5

$\frac{N}{P} \frac{P}{P} \frac{P}{P} \frac{P}{P}$
youngest # 2-3" W

7 [] *hemlock (leafy) stem*
youngest hemlock

3 [] *fallen down in*
red cones

2 [] *ch. cut (leaf) + vein*
(leaf) + paper etc.
along with young

A.M. 1:16
fresh, recorded; looking
fall gladden to leaf
ch. brown in leaf
1. stem fork of leaves

II K42

June 25, L.S. Creek

Flora of lowest belt,
beech: -

- | | |
|------------------|----------------|
| Asarum arif | Cyst frag |
| Hepatica | Adiantum |
| Erigeron | Polygon |
| Ranunc. rec | Aspl. adrost |
| Anemone | Actaea |
| Asteroid | Podoph |
| Eup. pan + urtic | Phloxidiv |
| Camph | Viola palm |
| Pulsat | Impatiens |
| Viola | Stellaria pul. |
| Smilax hisp. | Trellingr |
| Rubus | Nettle |
| Magn. trif | Camph |
| Pyrolaria | Arist. mac |
| Sp. ivy | Cross vine |
| | Hydr. can |

V. canad
Asarum canad
Smilacina
Anem. quinque

Bottoms of R. S. Creek

The beech woods
of both lower slopes
comes down into
the flat

Bottoms:

beech	bitternut
tulip	bird not y
burkewy	magnolia

Digitized by Hunt Institute for Botanical Documentation

Rock cliffs along
in stream
Iris crist
Sedum

An elm at edge of
stream - U. serot? ?

V. blanda

Looking up the S
slope -
can see that the oak
stand fairly soon

(1)

Forest as seen from
 creek; flat + lowland
 beech 24, 4, 6, 7, 6, 14 = 68
 wh. oak 1
 red oak 11 3
 sh b hick 11 7
 hick 1
 s maple 11 3
 basswood 11 7
 red maple 1
 chestnut 11 2
 cucumber 11 2
 elm 11 2
 buckeye 11 2
 nycag
 hickory 1
 94

Digitized by Hunt Institute for Botanical Documentation

(Add to above)

(2)

Forest of the bench:
 beech 13, 6, 9, 8 36
 s maple 11 7
 basswood 11 3
 buckeye 1
 ch oak 1
 red maple 1
 sh b hick 1
 50

Quercus Chestnut
 Phlox dr Smilax herb
 Trillium Polyp
 Hepatica Carex
 Eleph. ear Bloodroot

Cornus
amplicarpa
anemone

Digitized by Hunt Institute for Botanical Documentation

Long S. slopes (3)
 of Smetana Creek

beech	###	###	###	###	1	21
rh vib	###	###	###	###	11	17
basswood	##					2
red oak	###					4
hickory ^{alba}	###					4
cucumber	##					3
red maple						1
may hup				ash	##	2
dogwood				nyssa	###	4
chestnut				tulip	###	3
Phegop				<i>Sol. latif</i>		
Polyp				<i>Juncus</i>		
				<i>Seneo</i>		
Chimaph				<i>Viola pub</i>		
Smilax bn				<i>Asarum</i>		
mulberry				<i>blondrnt</i>		

Ares sep
 Corylus
 occ vac. vac
 Asp. n l
 Mitchell
 Aspl f f
 Cypr. par pnt

High up where
 ridges seem to
 disappear &
 slopes are not
 so steep
 valley open (4)

Digitized by Hunt Institute for Botanical Documentation

up

walnut 1			1
beech III III			10
Tulip II			2
sh b hick 1			1
rh rh II	2	elm 1	1
cucumber	1	doctraster 1	1
hasswood II II	4	butkeye	1
butternut 1	1	s. maple III	3

(5)

Valley of side stream (hump)

beech III II	7
hasswood II	2
s. maple 1	2
walnut III	4
butkeye II	2
Tulips III	5
sh b hick 1	1

Moss covered rocky
 trembling brook
 mitella
 Heuch. painted
 Mosses & liverworts
 Sedum
 walking ferns

Cornus alt.
 Benzoin

Digitized by Hunt Institute for Botanical Documentation

Upper part

Head of valley (6)

s maple	###		7
beech	###	###	18
basswood	###	###	10
tulip	###		4
buckeye	###		6
cucumber			1
ash			3
sh b hush			2
red oak			1
cladraster		→	1 Head

(7) Starting to climb mt

S maple	###	###	###	###	###	###	###	3
basswood	###	###	###	1				16
beech	###	###	###					17
Tulip	###							6
cucumber								1
buckeye	###		###					11

Chestnut		4
Cladrastis		3
elm		1
Hickory		4
Walnut		3
sh b beech	-1	6
red oak		1
(Walnut 2x + short way to knot)		943
(picture 7 in this)		
Mullery		1

(8) Above the beech

s maple		20
Hickory		8
baswood		13
Chestnut		5

Digitized by Hunt Institute for Botanical Documentation

tulip		6
beech		4
Hickory		5
ash		3
Mullery		1
ch oak		1
red maple		1
sh b beech		1
butternut		1
Nyssa		1
wh oak		1

gap

(Acorns colanmus)

Over into head of
SW flowing stream ✓

Wh oak	###	###	1	11
Chestnut	###	###	##	12
Cucumber				2
C. glabra				1
Smapple				3
Hickory	###	###		10
Tulip	###	###		10
Ch oak				4
ash				2
baswood				3
butternut				1
walnut				2
red oak				1

Digitized by Hunt Institute for Botanical Documentation

Fruit turns away
from branch & from
forest
axis of baswood &
increases downward

On SE side of

Pine Mt

vac. arborescens

Achroea (Stern)

Arabis spissa in

mossy-grassy ss

Cephalanthus

Clethra

Juncus

||

Saururus cetratus

Pyramnia *humboldtii*
Rosa *serotina*
Helianthus

Panicum claudet
Eup. mac

Digitized by Hunt Institute for Botanical Documentation

June 26

Chenoa to Clear Creek
Springs

Sparganium
Callitriche heterophylla

Lower slopes of Clear
Creek (S.E. slope) just
below Chenoa
a pure 2nd growth
stand tall with
understory of several
grasses

Sandstone rocks on
N.E. cut

Hierba pass. rug
Aspl. montanum

Ophryoglossa vally

Santhus

Croton monanth

Alcedia Teres

Creek

Clear, cuts the lower
dipping plateau of
Pine Mt., through
w. less craggy texture.

The steep slope cliffs
support masses of
Rhod.

The valley has Hemlock

Digitized by Hunt Institute for Botanical Documentation

holly, Rhod., Salix

In flatter parts -

Ames gum - alder

sometimes with

Sparganium

Back Cover

Digitized by Hunt Institute for Botanical Documentation



548

62

71

106

53

23

26

63

52

94

411

126

31

29

21

29

28

43

44

1283

411

324

548